

GRAND HYATT TOKYO

6-10-3 Roppongi, Minato-ku,
Tokyo 106-0032, Japan

+81 3 4333 1234 TELEPHONE

+81 3 4333 8123 FAX

tokyo.grand@hyatt.com

tokyo.grand.hyatt.com

GRAND | HYATT™

ACCOMMODATIONS

- 32-inch flat screen TV (HDMI compatible)
- 13-inch flat screen TV in the bathroom
- Complimentary Wi-Fi / Wired Internet access
- Two phone lines and voicemail
- Cable / satellite television channels
- DVD / CD player
- AV Panel for Bluetooth
- Portable speaker for iPhone / iPod touch
- Full blackout blinds
- Individual air-conditioning control
- Humidifier / air-purifier upon request
- Spacious bathroom, with separate shower, bath and dressing areas
- Hairdryer; robes
- Mini-bar
- Mineral water
- Crib upon request
- Safety deposit box, which allows a laptop to be charged while locked for safe keeping
- Morning newspaper

SERVICES & FACILITIES

- 24-hour Duty Manager
- Concierge service
- 24-hour in-room dining
- Business Center
- Airport and rental limousine
- Japanese and Western wedding facilities
- Laundry
- Valet parking
- Exclusive parking for 200 cars and extra parking available within Roppongi Hills
- Shops and boutiques in adjoining Roppongi Hills complex
- Hairdressing and beauty salon

RESTAURANTS & BARS

- *Fiorentina* – Italian café
- *Fiorentina Pastry Boutique* – takeaway cakes, pastries and sweets
- *The French Kitchen* – all-day dining
- *The Oak Door* – steakhouse
- *Shunbou* – Japanese cuisine
- *Roku Roku* – Edo-mae sushi
- *Chinaroom* – Chinese cuisine
- *Keyakizaka* – Teppanyaki
- *Maduro* – jazz lounge

MEETING & EVENT SPACE

- With 15 event facilities and 2,800 square meters of conference and meeting space, advanced technology and a dedicated team of event planning executives, Grand Hyatt Tokyo is one of Tokyo's most sophisticated conference hotels
- A 1,000-square-meter rectangular-shaped, pillar-less Grand Ballroom with 6.6-metre ceilings and able to seat 600 for dinner and 1,000 for cocktails is ideal for cocktails, coffee breaks and exhibitions
- Four Junior Ballrooms (Residence Anise, Residence Basil, Coriander, Tarragon) suitable for medium-size conferences
- An exclusive Drawing Room and three meeting rooms (Laurel, Lavender, Thyme) are appropriate for breakout sessions or separate meetings. Thyme (200 square meters) can be divided by partitions and used as five smaller spaces
- Two uniquely designed authentic coffee and bar counters are available in both foyers

RECREATIONAL FACILITIES

- *Nagomi Spa and Fitness* – the stunning facility provides a total revitalisation experience with a unique stone swimming pool surrounded by a hardwood deck, whirlpool and relaxation area. The facility also features a state-of-the-art gymnasium, aesthetic salon, treatment rooms and sauna facilities

LOCATION

Located in the heart of Roppongi, known worldwide as Tokyo's center for business, commerce and entertainment, Grand Hyatt Tokyo is part of Roppongi Hills, one of Japan's largest private urban cultural center and is conveniently located close to Tokyo's famed Ginza shopping district, Kasumigaseki government district.

DIRECTIONS

A major international airport, Narita airport, and a domestic airport, Haneda airport, serve Tokyo. The hotel is also 30 minutes by car from Tokyo Station (Marunouchi).

POINTS OF INTEREST

- Roppongi Hills
- Imperial Palace
- Shinjuku Gyoen Park
- Shinjuku district
- Asakusa Kannon Temple
- Meiji Jingu (shrine)
- Omotesando fashion district
- Tokyo Disney Resort
- Tokyo National Museum
- Tsukiji fish market
- Ueno Park and Zoo
- Sensoji Temple
- National Museum of Modern art
- Tokyo Midtown
- Tokyo Skytree



GRAND HYATT TOKYO

6-10-3 Roppongi, Minato-ku,
Tokyo 106-0032, Japan

+81 3 4333 1234 TELEPHONE

+81 3 4333 8123 FAX

tokyo.grand@hyatt.com

tokyo.grand.hyatt.com



GRAND | HYATT™

CAPACITY CHART



REAR SCREEN PROJECTOR ○
PROJECTOR ●
LED SCREEN ◎

ROOM NAME	ROOM HEIGHT FT. / M.	ROOM SIZE SQ. FT. / SQ. M.	BANQUET	RECEPTION	THEATER	CLASSROOM	BOARDROOM	U-SHAPE	
2F									
CORIANDER	12.8 3.9	3,444 320	180	200	300	180	—	60	◎
RESIDENCE BASIL	13.1 4	2,476 230	130	150	280	135	—	45	●
<i>Kitchen</i>	— —	645 60	—	—	—	—	—	—	—
RESIDENCE ANISE	13.1 4	2,045 190	120	120	220	105	—	40	●
DRAWING ROOM	12.8 3.9	1,507 140	50	80	—	—	18	—	●

3F

GRAND BALLROOM	21.7 6.6	1,000 10,764	600	1,000	1,200	720	—	—	○
<i>Grand Ballroom East</i>	21.7 6.6	5,382 500	300	350	550	300	—	80	○
<i>Grand Ballroom West</i>	21.7 6.6	5,382 500	300	350	550	300	—	80	○
TARRAGON	12.8 3.9	3,444 320	180	200	300	180	—	60	○

4F

THYME	10.5 3.2	2,583 240	50	80	216	117	60	60	●
<i>A-E each room</i>	— —	431 40	—	—	—	—	6	—	—
<i>A-E two rooms combined</i>	— —	861 80	30 Thyme D-E	40 Thyme D-E	72	45	24	24	● Thyme A-B
<i>A-E three rooms combined</i>	— —	1,292 120	40 Thyme C-D-E	60 Thyme C-D-E	120	72	36	30	● Thyme A-B
<i>Kitchen</i>	— —	431 40	—	—	—	—	—	—	—
LAUREL	10.5 3.2	807 75	—	—	50	25	20	15	○
LAVENDER	10.5 3.2	807 75	—	—	50	25	20	15	○

GRAND HYATT TOKYO

6-10-3 Roppongi, Minato-ku,
Tokyo 106-0032, Japan

+81 3 4333 1234 TELEPHONE

+81 3 4333 8123 FAX

tokyo.grand@hyatt.com

tokyo.grand.hyatt.com



GRAND | HYATT™

FLOOR PLAN

1F

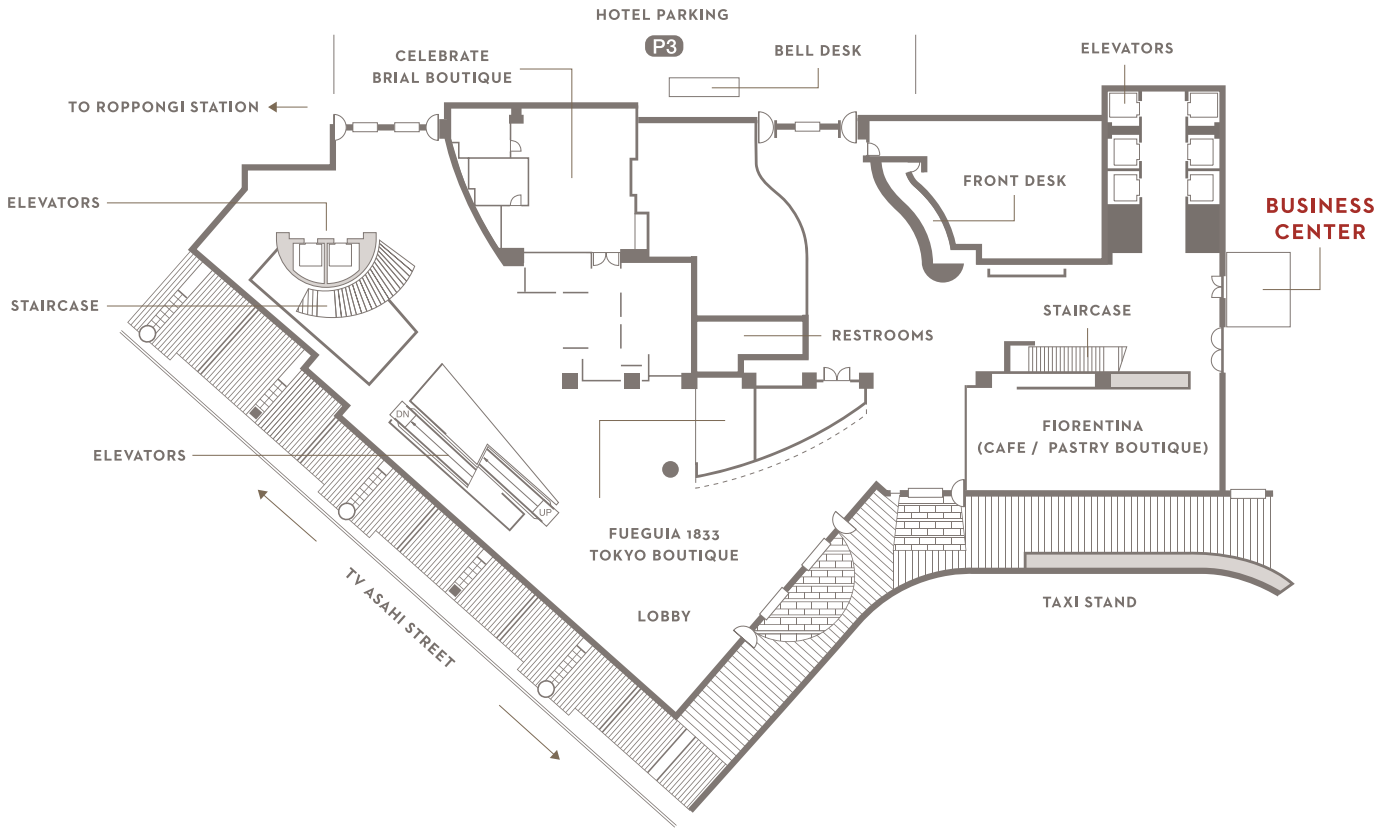

GRAND HYATT TOKYO

6-10-3 Roppongi, Minato-ku,
Tokyo 106-0032, Japan

+81 3 4333 1234 TELEPHONE

+81 3 4333 8123 FAX

tokyo.grand@hyatt.com

tokyo.grand.hyatt.com



GRAND | HYATT™

FLOOR PLAN

2F

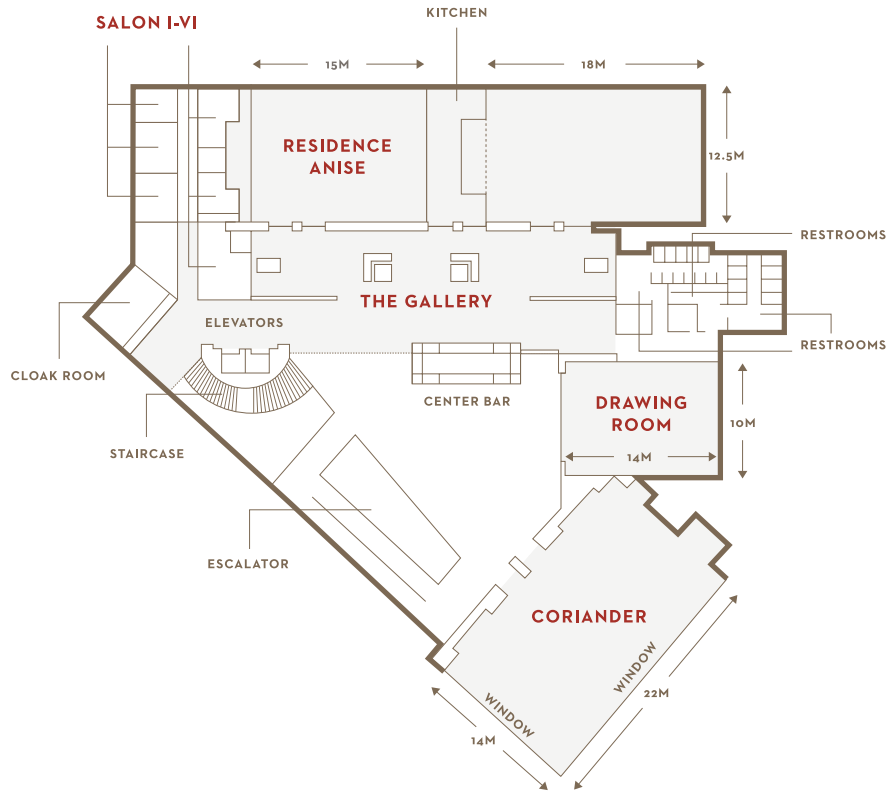

GRAND HYATT TOKYO

6-10-3 Roppongi, Minato-ku,
Tokyo 106-0032, Japan

+81 3 4333 1234 TELEPHONE

+81 3 4333 8123 FAX

tokyo.grand@hyatt.com

tokyo.grand.hyatt.com



FLOOR PLAN

3F

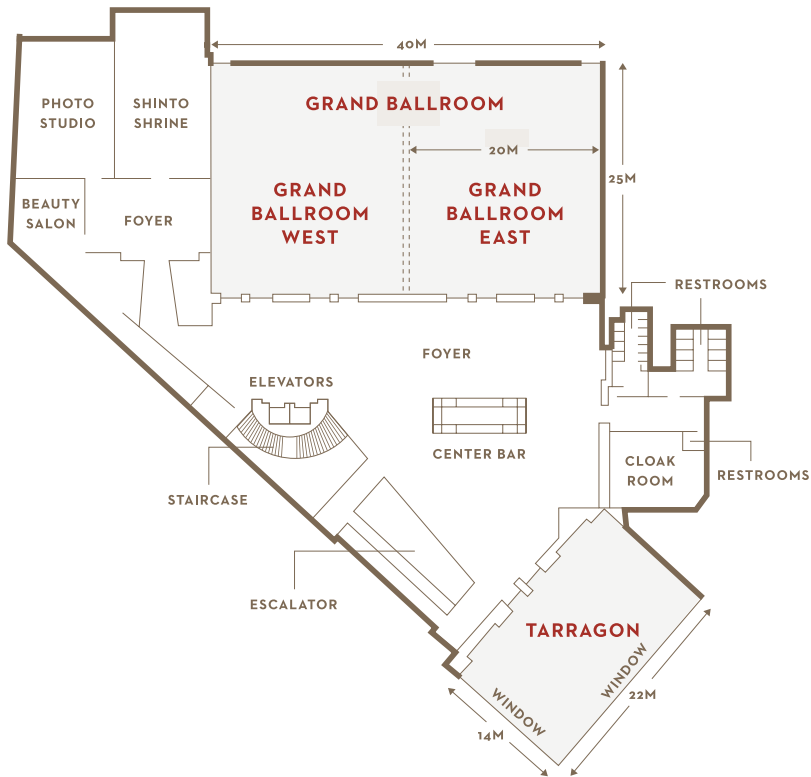

GRAND HYATT TOKYO

6-10-3 Roppongi, Minato-ku,
Tokyo 106-0032, Japan

+81 3 4333 1234 TELEPHONE

+81 3 4333 8123 FAX

tokyo.grand@hyatt.com

tokyo.grand.hyatt.com



FLOOR PLAN

4F

